



arcit

Design "till its feels like home"

[View Sample E-book](#) 



Content



Project id-27389

Project location :Kerala

Plot Area :9 cent/364sqm

Floor Area :1000sqft

BHK :2BHK

No. of floors :G+0

No. of rooms :2

No. of car parks :1

Requirments :2bhk
:Budget home
:Courtyard
:Open kitchen
:Prayer room
:Yoga space

Style :Tropical

ExteriorElements :Columns
Sloping roof
Flat roof
Tiled roof
Jalli/Cnc

Interior Elements :Brick texture
Wood finish
Designer lights
Koi pond

Interior Elements :Planter box
Pavements
Lawn
Outdoor seating

Estimated Budget :10 Lakhs

Site Plan

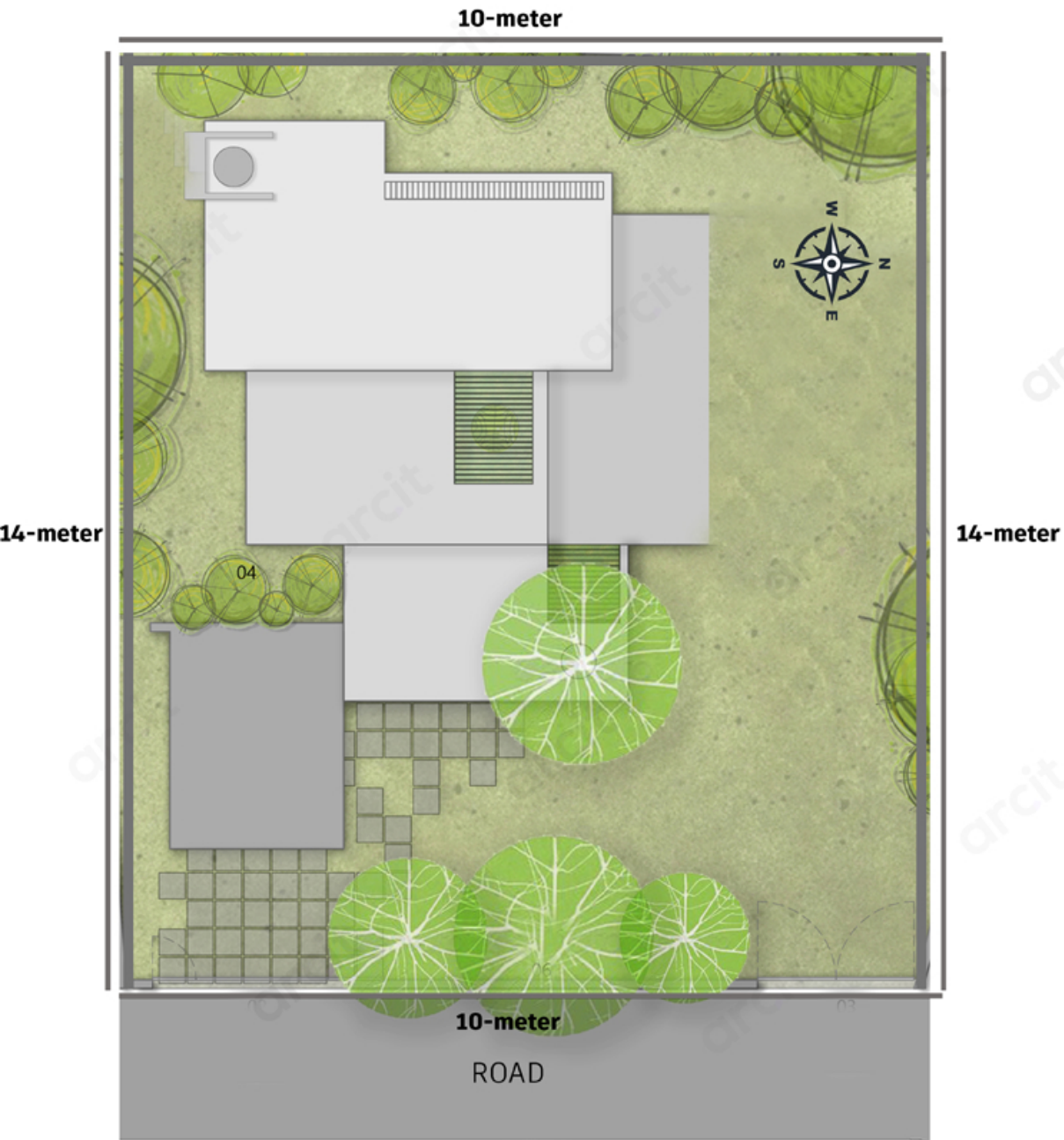

Plot details

Plot Front facing direction :East

Plot side dimension :14m

Plot front dimension :10m

Plot neighbourhood :

Front side :Road

Left side ;Neighbourhood

Right side ;Neighbourhood

Back side ;Neighbourhood

Other details :

Flood affected area :No

Consider Vastu :Yes

Floor Plans (sample)

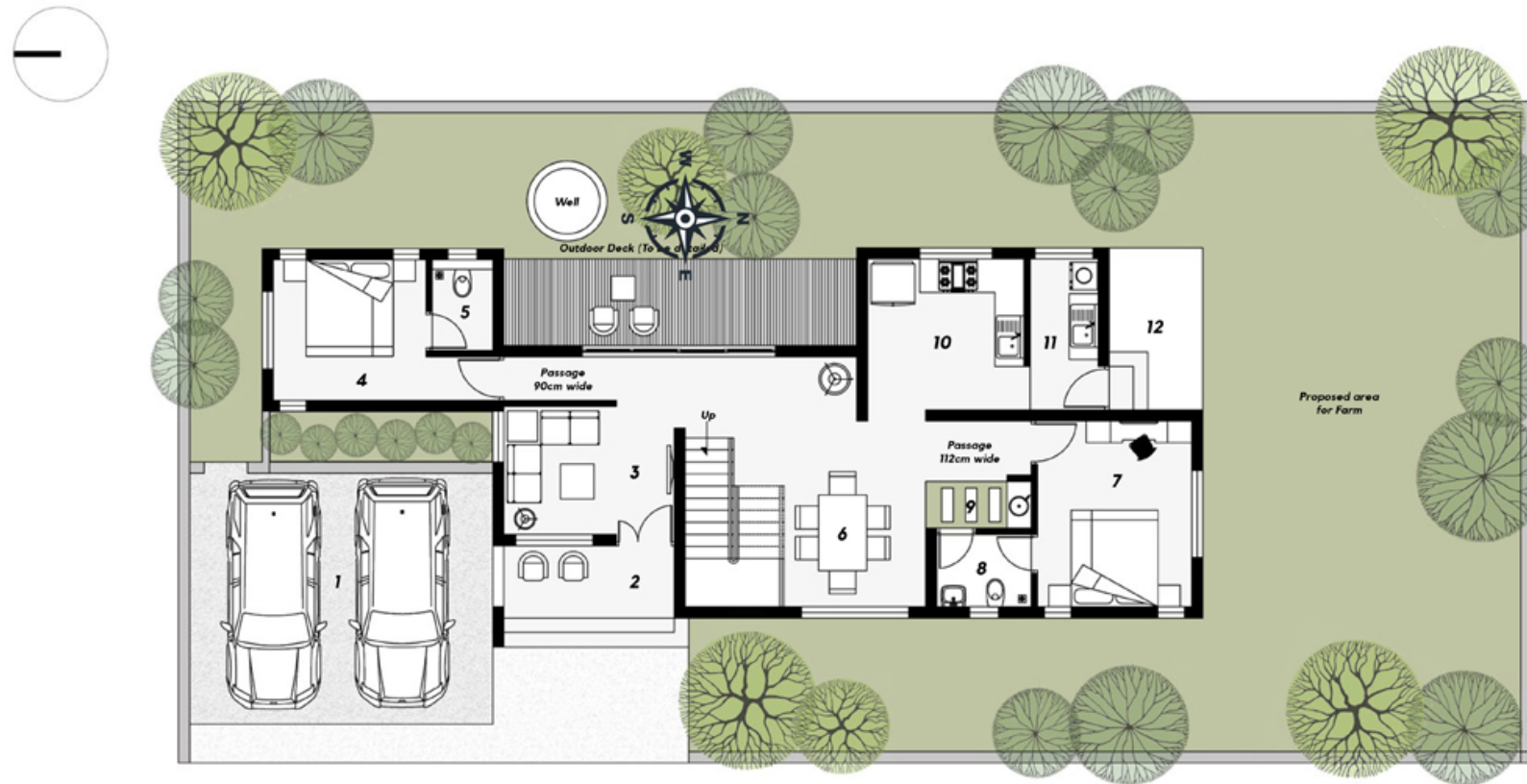

Ground Floor Plan

LEGEND

- 1. Car Port - 625x520cm
 - 2. Sitout - 352x150 cm
 - 3. Living Room - 352x265cm
- AREA-1156sq ft

- 4. Bedroom - 315x290cm
- 5. Toilet - 125x188cm
- 6. Dining Room - 295x385cm

- 7. Bedroom- 320x385cm
- 8. Toilet- 195x150cm
- 9. Wash

- 10. Kitchen - 323x313cm
- 11. Work Area - 140x313cm
- 12. Utility Area

3d Plans_(sample)



3d Views_(sample)



3d Views_(sample)



Mood Boards (sample)



Color Palette:

Warm neutral colors such as beige, cream, and taupe
Accents of deep blue or forest green for contrast
Hints of metallics like brass or gold for a touch of glam

Textures:

Soft and cozy fabrics such as velvet, faux fur, and chunky knit
Natural materials such as wood, rattan, and jute for a rustic touch
Shiny and reflective surfaces like glass or metallics for some visual interest

Furniture:

Large and comfortable sectional sofa in a neutral color
Matching armchair and ottoman for extra seating and relaxation
Wooden coffee table with clean lines and a natural finish
Coordinating side tables with metallic accents for visual interest

Decor:

Plush throw blankets and decorative pillows in various textures
Large area rug in a neutral color to anchor the space
Framed art prints in coordinating colors and themes
Floor or table lamps with warm-toned bulbs for cozy lighting
Potted plants or fresh flowers to bring in some natural elements

Interior Design_(sample)



Interior Design_(sample)



Landscaping Design (sample)



Hardscaping:

A pathway leading from the driveway to the front door made of natural stone pavers

A small patio area in the backyard made of stamped concrete with a built-in fire pit and seating area

Plant selection:

A mix of evergreen trees such as pine and spruce to provide privacy and year-round interest

Shrubs such as boxwood and hydrangea to add color and texture

Perennial flowers such as daylilies and coneflowers for seasonal interest

Color scheme:

A neutral color palette with pops of blue and purple in the flowers

Natural stone pavers and wooden garden beds add warmth to the design

Lighting:

Low-voltage landscape lighting to highlight the trees and hardscaping features

A string of outdoor lights on the patio area for ambient lighting

Water features:

A small pond with a water fountain for a calming and relaxing element in the backyard

Edging:

Stone edging around the garden beds to define the space and prevent erosion

Maintenance:

Native and drought-resistant plants chosen for low-maintenance upkeep

Regular pruning and mulching to keep the landscape design looking neat and tidy

Cost Effective Ideas_(sample) Will help to reduce construction cost by 30%-50%

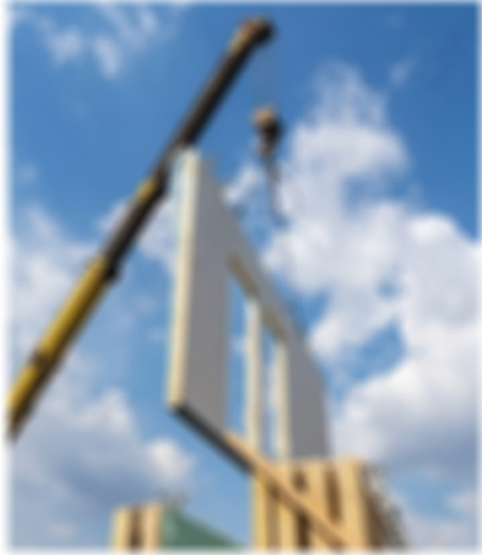

Prefabricated or modular homes:

These homes are constructed off-site in a factory and then transported to the building site for assembly. They can be a more affordable option as they are mass-produced and often require less labor and materials than traditional stick-built homes.



Concrete block

construction. This method involves building walls using precast concrete blocks. Concrete blocks are relatively cheap, and they can be assembled quickly, reducing labor costs.



Hybrid construction:

This is a hybrid method that combines the benefits of prefabricated and stick-built homes. Panels are constructed off-site and then assembled on-site, reducing labor costs and construction time.

Green building materials:

Using sustainable and eco-friendly building materials can not only be cost-effective, but it can also reduce long-term operating costs by improving energy efficiency and reducing maintenance requirements.

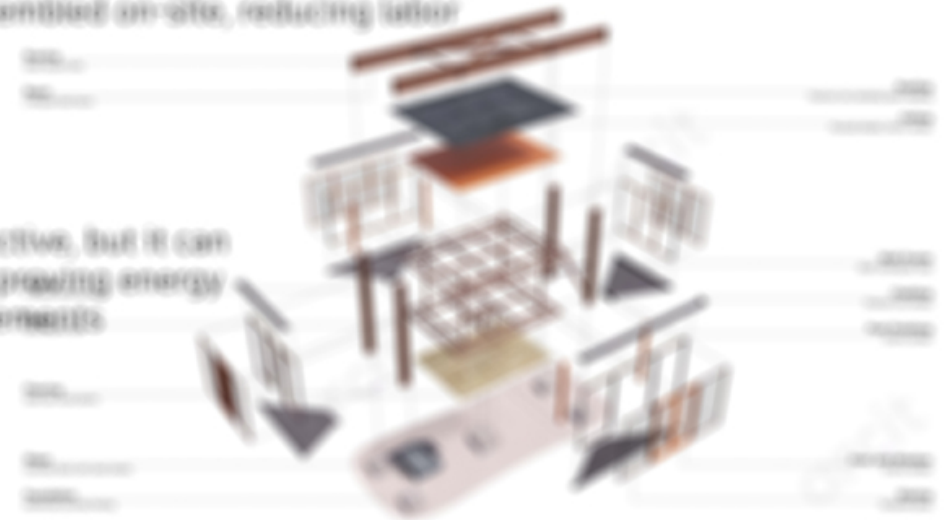

Estimation_(sample)

Approximate cost on various work of materials per thumb rule

Cement (16.4 %)	1,64,000.00 Rs.
Sand (12.3 %)	1,23,000.00 Rs.
Aggregate (7.4 %)	74,000.00 Rs.
Steel (24.6 %)	2,46,000.00 Rs.
Finishers (16.5 %) (Paint (4.1 %) + Tiles (8.0 %) + Bricks (4.4 %))	1,65,000.00 Rs.
Fittings (22.8 %) (Window (3.0 %) + Doors (3.4 %) + Plumbing (5.5 %) + Eletrical (6.8 %) + Sanitary (4.1 %))	2,28,000.00 Rs.
TOTAL COST	10,00,000.00 Rs.

Phase : Percentage of construction costs INR in %

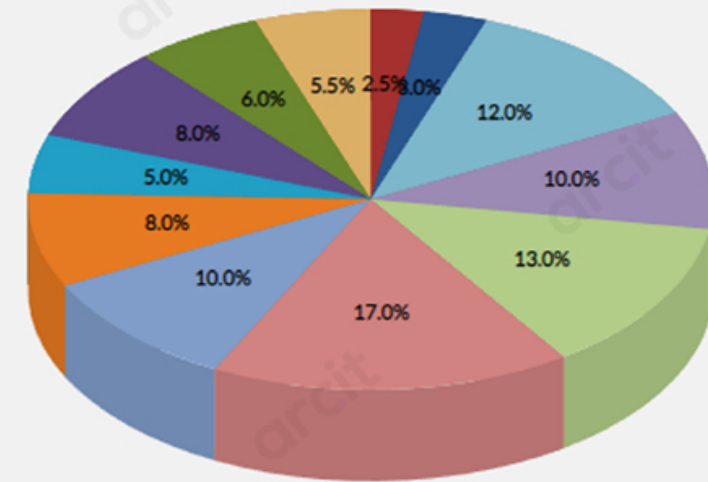

Estimation_(sample)

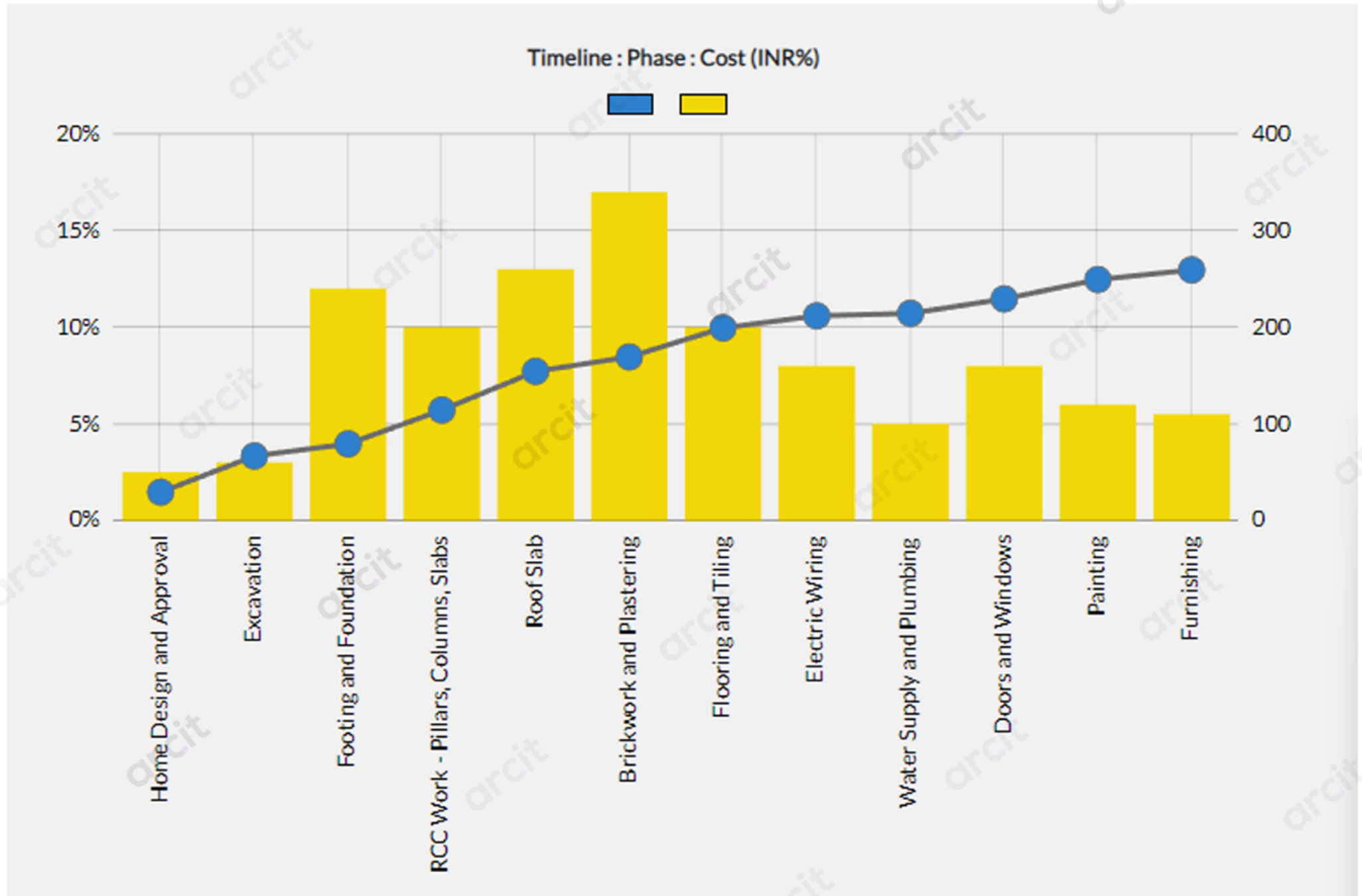

To complete this construction in **6 months** timeline money required is as below

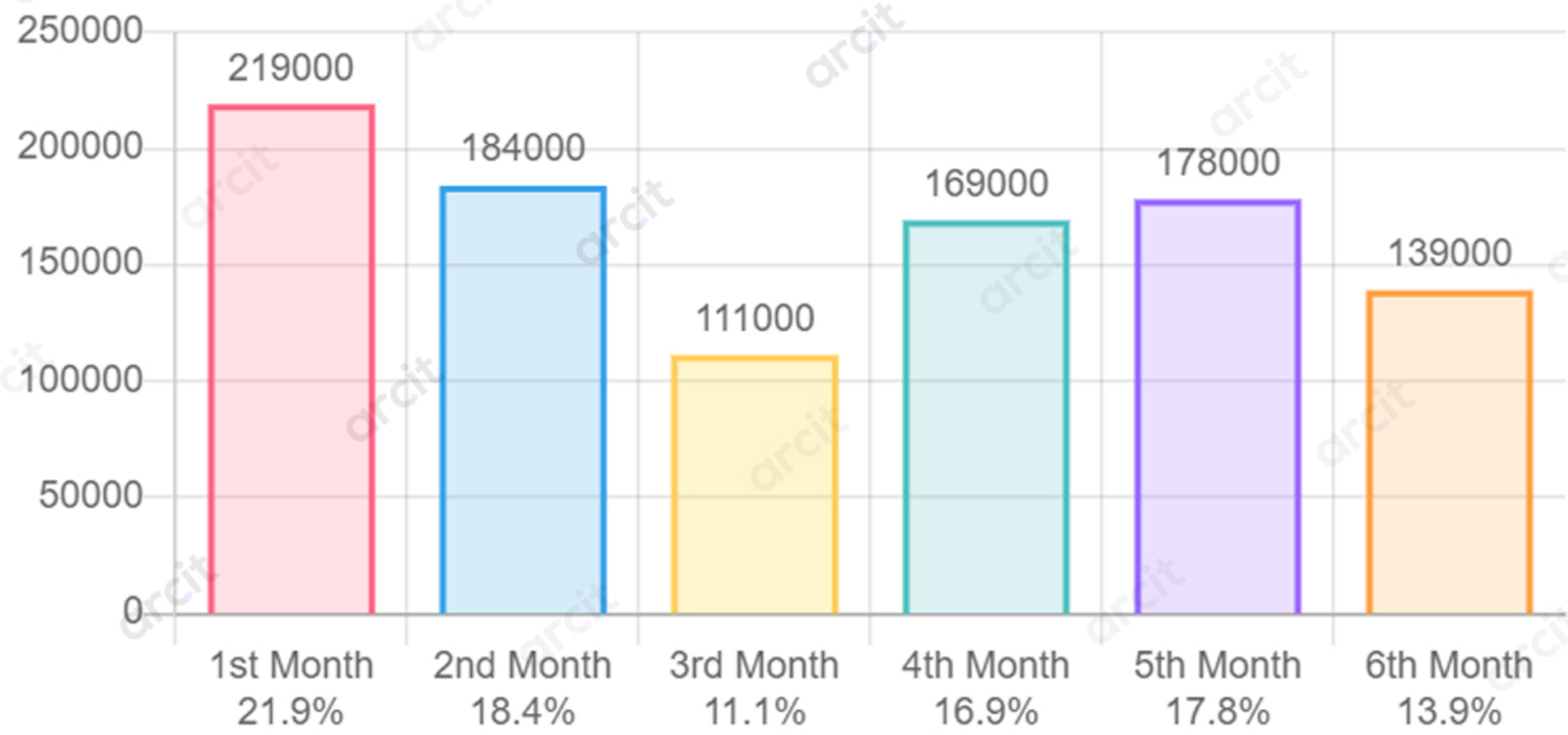

Estimation_(sample)

Approximate **cost on various work of material** to complete the construction for **1000 ft²**

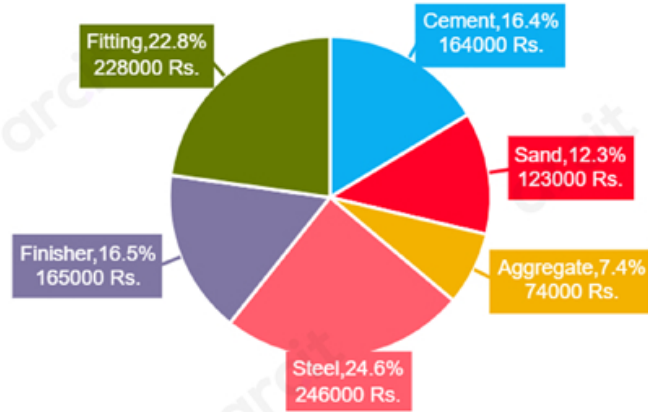

Amount of Aggregate Required
 = Builtup area × 0.608
 = 1000 × 0.608
 = 608.00 Ton

Aggregate Amount
 = $\frac{7.4}{100} \times \text{Total cost}$
 = $\frac{7.4}{100} \times 1000000.00$
 = 74000.00 Rs.

Note: Amount of aggregate required per 1 ft² = 0.608 ton & 7.4%

Amount of Steel Required
 = Builtup area × 4
 = 1000 × 4
 = 4000.00 Kg.

Steel Amount
 = $\frac{24.6}{100} \times \text{Total cost}$
 = $\frac{24.6}{100} \times 1000000.00$
 = 246000.00 Rs.

Note: Amount of steel required per 1 ft² = 4 ton & 24.6%

Amount of Paint Required
 = Builtup area × 0.18
 = 1000 × 0.18
 = 180.00 lt

Note: Amount of paint required per 1 ft² = 0.18 lt. & 4.1%

Amount of Bricks Required
 = Builtup area × 8
 = 1000 × 8
 = 8000.00 Pcs.

Cement	Bag	450	UltraTech Weatherplus	₹154350
Steel	KG	3500	Medium Grade	₹161000
Bricks	Per Piece	19000	Medium Grade	₹133000
Aggregate	Per Cubic feet	1900	Medium Grade	₹62700
Sand	Per Cubic feet	2000	Medium Grade	₹72000
Flooring	Per Sq feet	1000	Medium Grade	₹98000
Windows	Per Sq feet	170	Medium Grade	₹35020
Doors	Per Sq feet	180	Medium Grade	₹48060
Electrical fittings	Per Sq feet	150	Medium Grade	₹11700
painting	Per Sq feet	6000	Medium Grade	₹132000
Sanitary Fittings	Per Sq feet	1000	Medium Grade	₹60000
Kitchen Work	Per Sq feet	55	Semi Modular	₹44605
Contractor(RCC,BrickWork,plasterwork)	Per Sq feet	1000	Medium Grade	₹190000
Total Amount			INR	1202435

Architectural drawings (sample)



Architectural drawings (sample)

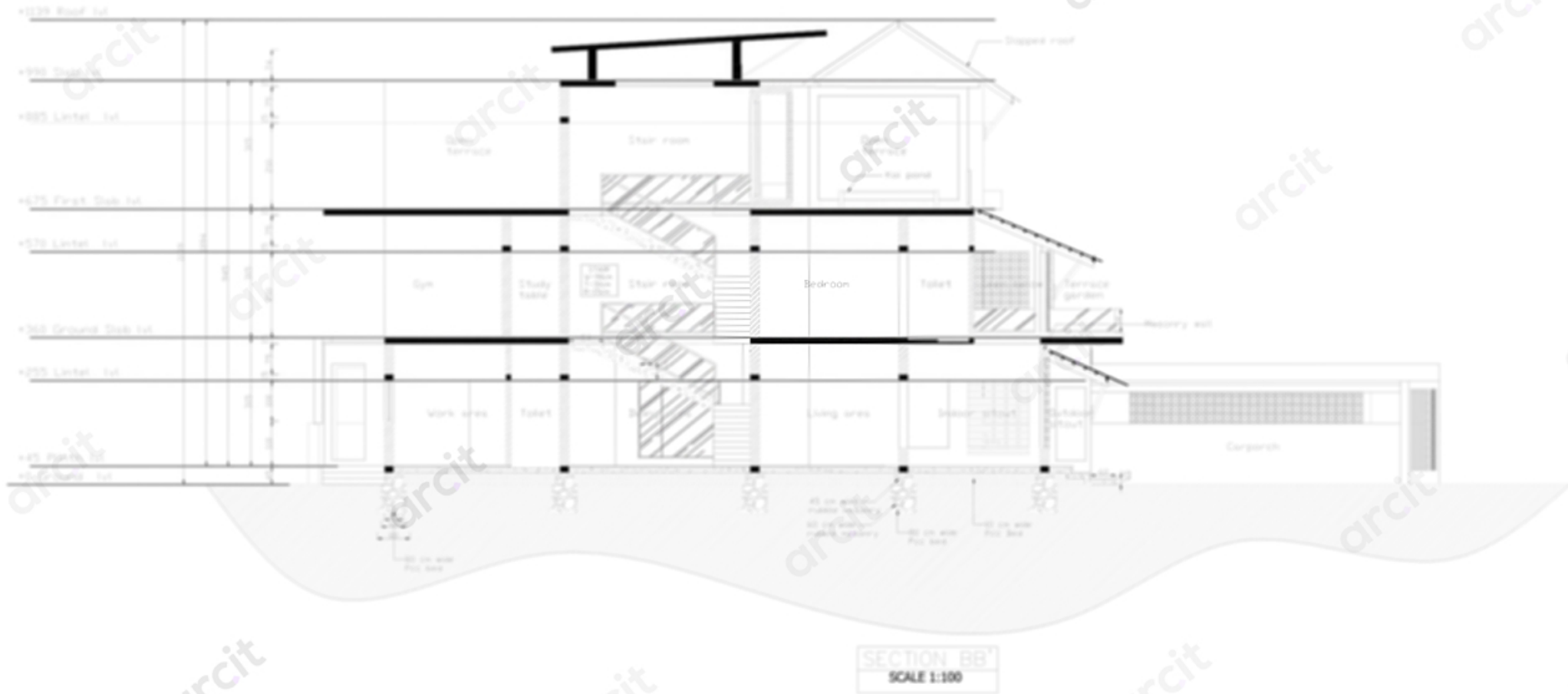

Structural drawings (sample)

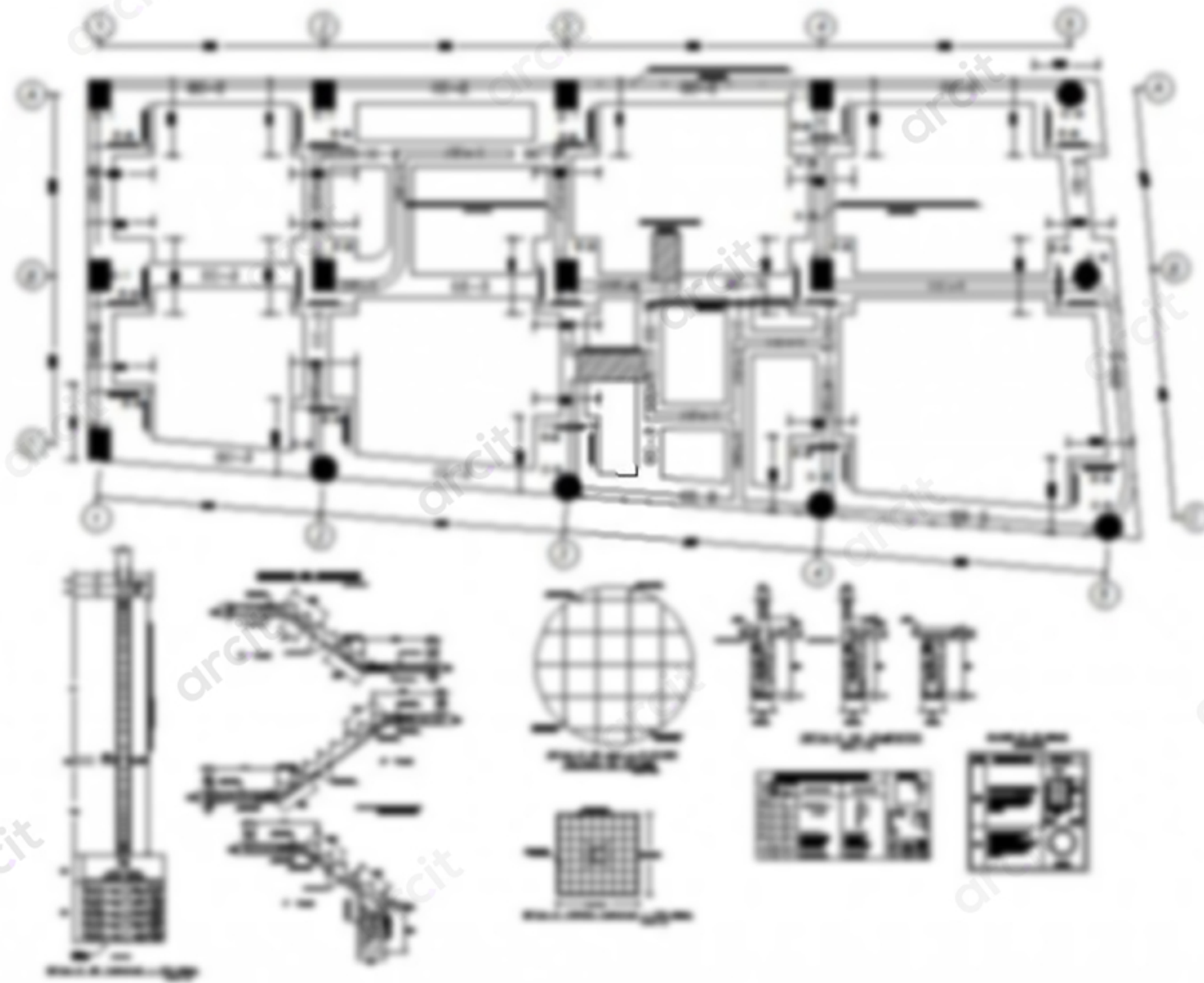

Structural drawings_(sample)

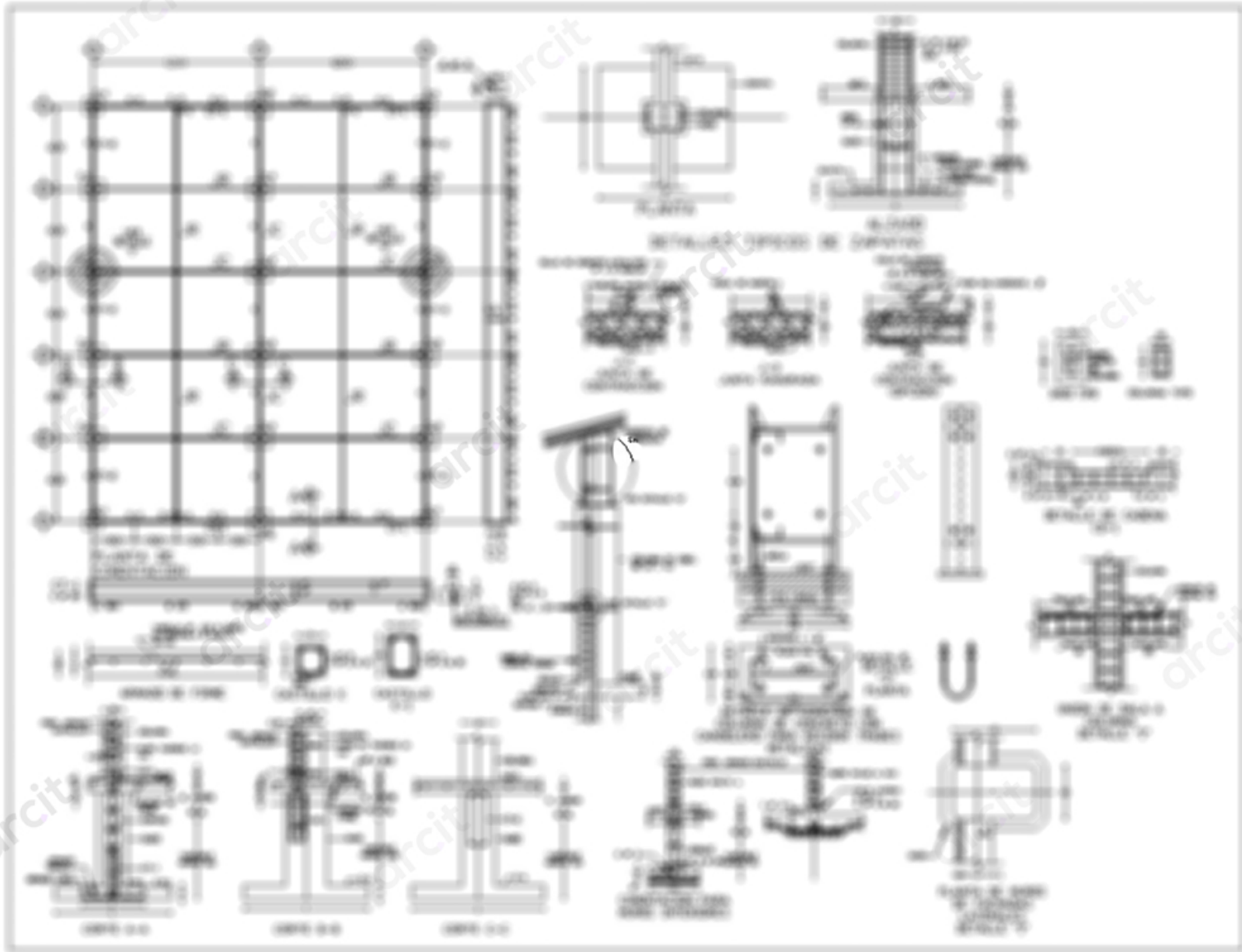

Source Files_(sample)

Source File

All 3d and 2d drawing files will be available for download

